

Codice 611

Curva a 90° a saldare ricavata da tubo elettrounito

- Materiale: Disponibile sia in AISI 304 che in AISI 316
- 90° welding elbow - Butt welding fitting

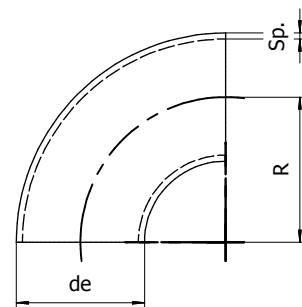

Diametro esterno			Spessore mm. (Sp)	Raggio di curvatura mm. (R)
DN	Pollici	mm. (de)		
10	3/8	17,2	2,0	28
15	1/2	21,3	2,0	31
			3,0	
20	3/4	26,9	2,0	29
			3,0	
25	1	33,7	2,0	38
			3,0	
32	1 1/4	42,4	2,0	48
			3,0	
40	1 1/2	48,3	2,0	57
			3,0	
50	2	60,3	2,0	76
			3,0	
65	2 1/2	76,1	2,0	95
			3,0	
80	3	88,9	2,0	114
			3,0	
90	3 1/2	101,6	2,0	133
			3,0	
100	4	114,3	2,0	152
			3,0	
125	5	139,7	2,0	190
			3,0	
150	6	168,3	2,0	229
			3,0	
200	8	219,1	2,0	305
			3,0	
250	10	273	2,0	381
			3,0	
300	12	323,9	2,0	457
			3,0	
350	14	355,6	3,0	533
400	16	406,4	3,0	610
450	18	457,2	3,0	686
500	20	508	3,0	762
			4,0	

