

# Inox Forniture

Codice 81A

VITI IMPRONTA A CROCE CON TESTA SVASATA PIANA

- Cross recessed countersunk flat head screws

Materiale:

A2 (AISI 304)

A4 (AISI 316)

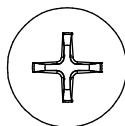
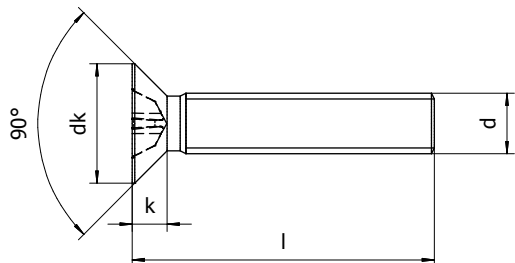

- DIN 965 - UNI 7688 - ISO 7046
- Testa svasata impronta a croce.
- Filettatura Metrica.
- Passo Grosso.
- Lunghezza misurata da sopra la testa.

d	M2	M2,5	M3	M4	M5	M6	M8
Passo			0,5	0,7	0,8	1	1,25
dk	3,8	4,7	5,6	7,5	9,2	11	14,5
k	1,2	1,5	1,65	2,2	2,5	3	4
N° Phillips 	0	1	1	2	2	3	4

L/D	M2	M2,5	M3	M4	M5	M6	M8
3	X	X					
4	X	X	X				
5	X	X	X	X			
6	X	X	X	X	X SOLO A2		
8	X	X	X	X	X	X	
10	X	X	X	X	X	X	X
12	X	X	X	X	X	X	X
14	X	X	X	X	X	X	X
16	X	X	X	X	X	X	X
20	X	X	X	X	X	X	X
25		X	X	X	X	X	X
30			X	X	X	X	X
35			X	X	X	X	X
40			X	X	X	X	X
45			X	X	X	X	X
50			X	X	X	X	X
60				X	X	X	X
70					X	X	X
80					X	X	X
90						X	X
100						X	X

Contrassegnate con la "x" tutte le misure standard

rev.01 del 24/09/2014

[www.inoxforniture.it](http://www.inoxforniture.it)

